

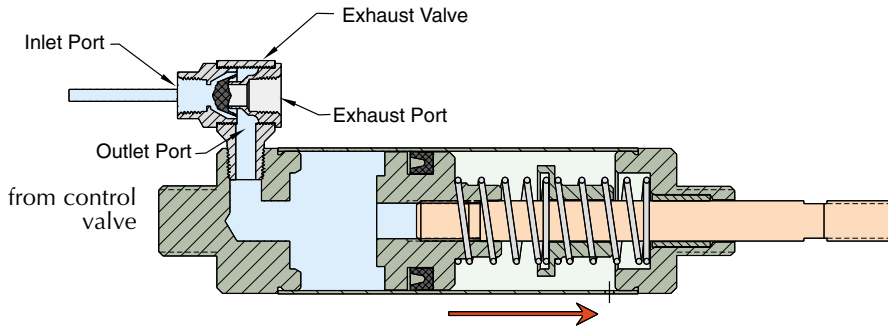

EXHAUST VALVES

EXHAUST VALVE APPLICATION

Cylinder Extends



In a typical application the exhaust valve is installed in the inlet of a spring return or double acting pneumatic cylinder.

Supply air from a control valve is directed into the inlet port of the exhaust valve. The Buna-N poppet seals the exhaust port and allows air to flow from the outlet port of the valve into the cylinder.

The pressurized air pushes against the piston and extends the rod, compressing the spring, until full rod extension is achieved.

Cylinder Retracts - Fast!

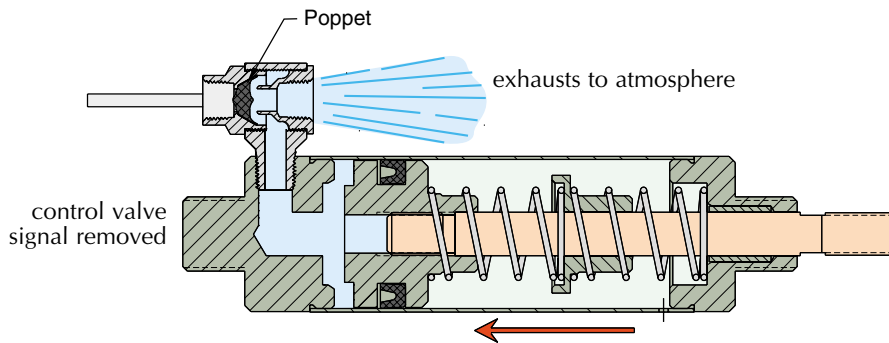

When the control valve exhausts air from the exhaust valve inlet port, the Buna-N poppet shifts to seal the inlet port and open the exhaust port to the cylinder. The pressurized air is allowed to exhaust directly through the exhaust valve to atmosphere.

Normally the air must travel back through the long air line to the control valve to exhaust. By mounting the exhaust valve directly on the cylinder, the piston retracts quickly since the distance to atmosphere is very short and unrestricted.

MEV-2

Poppet type quick exhaust valve. Brass body, Buna-N poppet

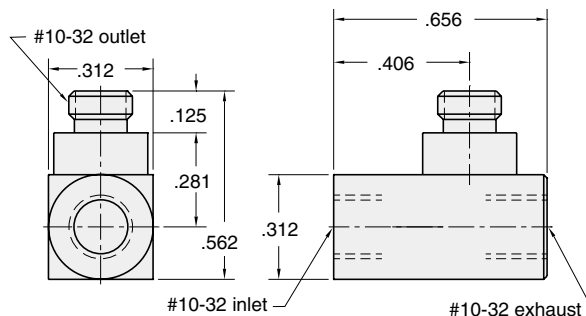

Medium: air

Working Range: 15-150 psig max.

Air Flow: @50 psig - 5 SCFM
@100 psig - 9 SCFM (exhaust rate)

Mounting: Direct to cylinder

Ports: Inlet -10-32 female
Outlet -10-32 male
Exhaust -10-32 female

Pressure to Shift: @ 50 psig - opens after approx. 5 psig drop

Temperature Range: 32° to 230° F

Note: Not for use with cylinders larger than 7/8" dia.; moderate strokes up to 10"

J-SERIES EXHAUST VALVE

Clippard's J-Series Exhaust Valve offers a variety of design features and provides fast response times and high flow with 1/8 and 1/4 NPT ports. This compact poppet type valve is constructed of brass and is 100% tested to assure the highest quality. The JEV's primary function is to increase cylinder speed. However, it also enables the use of smaller directional valves, longer control lines and can be used as a shuttle valve.

J E V -
|
J-Series Exhaust Valve

Inlet Thread Size

2 - 1/8" pipe
4 - 1/4" pipe

Outlet Thread Type

M - Male Thread
F - Female Thread



Inlet Thread Type

M - Male Thread
F - Female Thread

Outlet Thread Size

2 - 1/8 NPT
4 - 1/4 NPT

JEV-F2F2

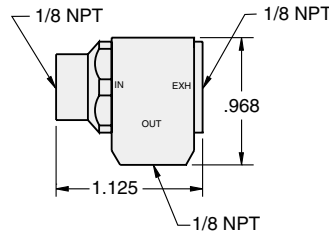

JEV-F4F4

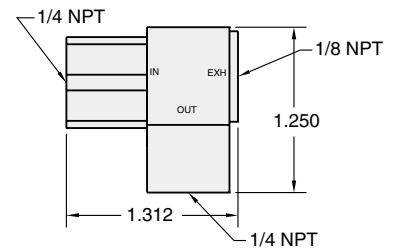

JEV-F2M2

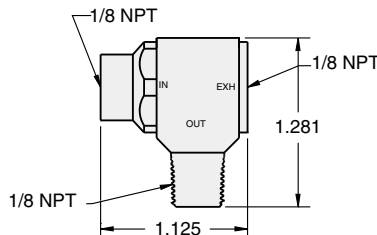

JEV-F2M4

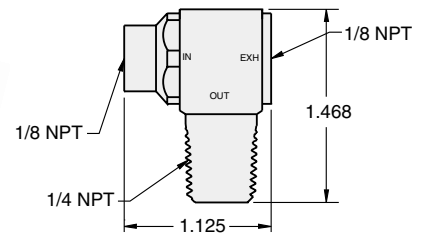

JEV-F4M4

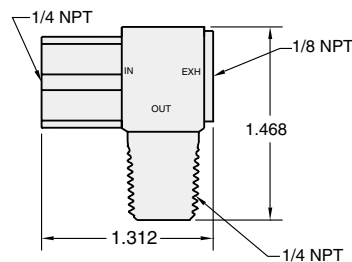

Features

- Enables use of smaller control valves
- 15 to 150 psig maximum
- Male outlet offers direct connection to cylinder
- 36 SCFM @ 50 PSIG and 58 SCFM @ 100 PSIG
- Low shift ratio
- 5 standard configurations
- Custom configurations also available
- Brass construction with molded Buna-N seal